

EXISTING EXTERNAL STORAGE OUTBUILDINGS
indicated in yellow & are understood to comprise the larger blockwork unit (35m²) largely serving Parish storage & the smaller steel container unit (15m²) serving Carnival storage (smaller Sports storage items are stored in the existing changing rooms with larger items, principally goalposts, stored in the open within compound)

PROPOSED:
1) smaller steel container unit to be replaced entirely by storage forming part of the proposed building & totalling around 29m²
2) blockwork unit to be replaced by new freestanding building of equivalent area as indicated

OVERALL NEW FOOTPRINT
= 477m²
EXISTING PAVILION FOOTPRINT
= 227m²

SOME COMPARATIVE AREAS:
Existing Pavilion:
- Function Room approx 65m²
- Kitchen approx 9m²
- Changing Rooms only approx 12m²
Eynsham Village Hall:
- Main Hall 151m²
- Small Hall 73m²
- Kitchen approx 26m²

STORAGE COMPOUND
EXISTING = 292m²
PROPOSED = 283m²

Extg un-named tree forming part of the continuing tree screen
Existing tree screening beyond this point retained

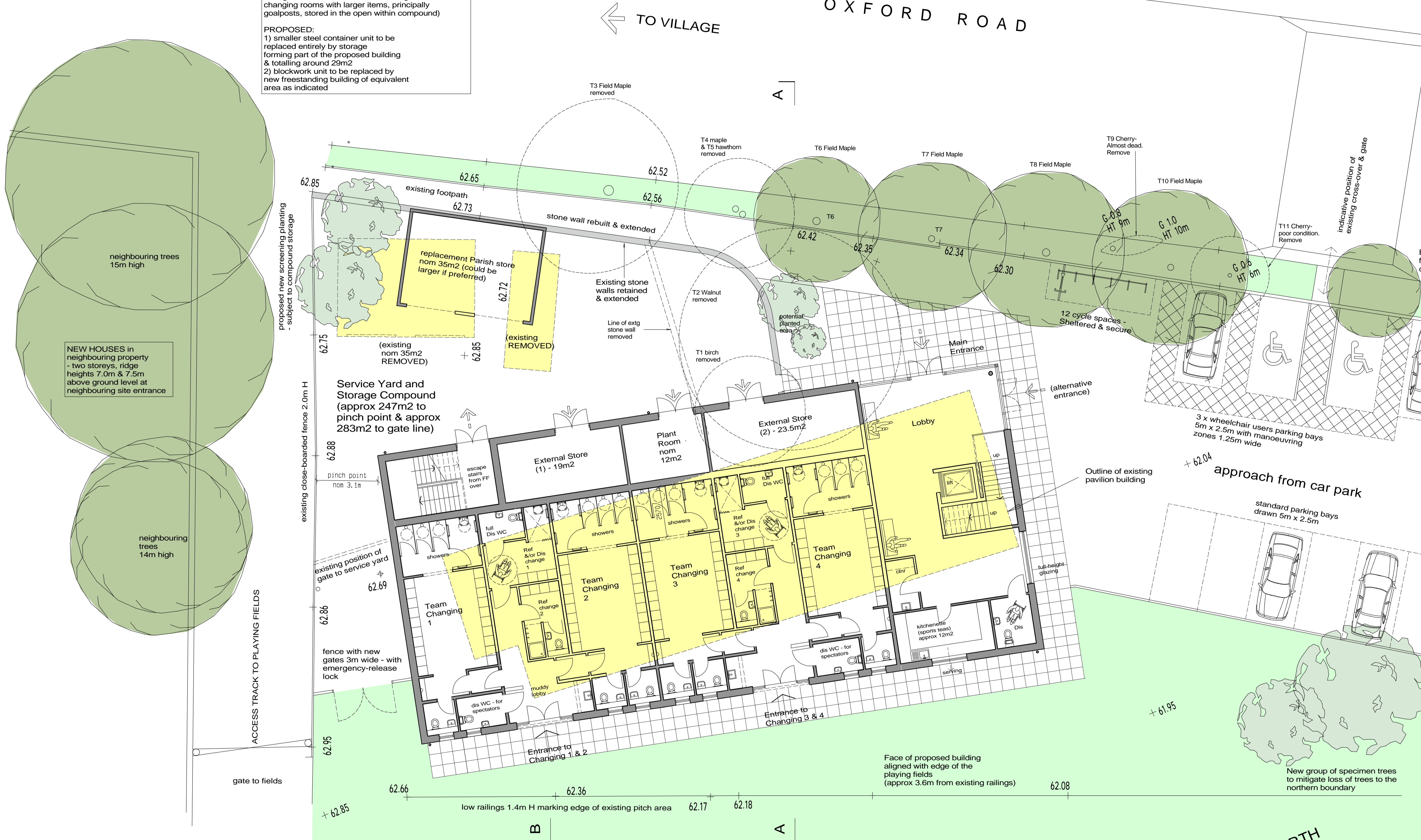
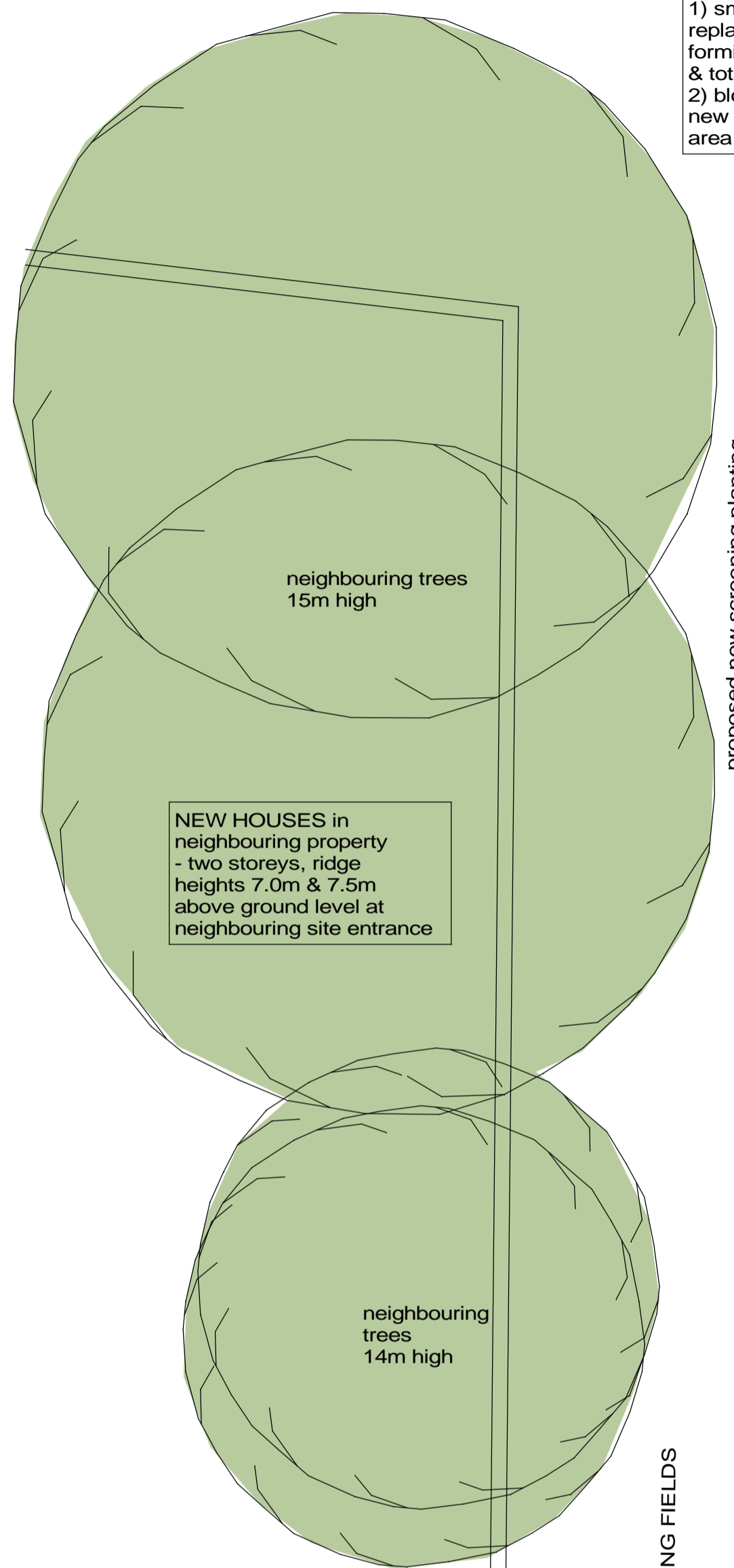

EYNSHAM SPORTS PAVILION
GROUND FLOOR & SITE PLAN
ORIENTATION OPTION 'C'
scale 1:200 @ A3

Revisions	Date	by	Rev
6.11.20			P3
Aug 2020	7.8.20		P1

Client
Eynsham Parish Council

Project
EYNSHAM SPORTS PAVILION
Oxford Road Eynsham

PROPOSED SITE AND
BLOCK PLAN -
(Orientation Option C)



STANHOPE WILKINSON ASSOCIATES
ARCHITECTS
2 Swinford Farm Eynsham Oxford OX29 4BL
(01865) 883222
E-mail: office@swa-architects.co.uk

Scales	Date	by
1:100 @ A1	Aug 2020	SW
1:200 @ A3		

Job No.	Drawing No.	Rev.
18366	600	P3